



Signature

The Joshua

The Trailway Collection at Paradise Trails





Elevation A



Elevation B



Elevation C

Signature



Standard Plan (2170 sq ft) | Two-Story

3 Bedrooms | 2.5 Bathrooms | 2 Car Garage

Signature

Available Plan Options

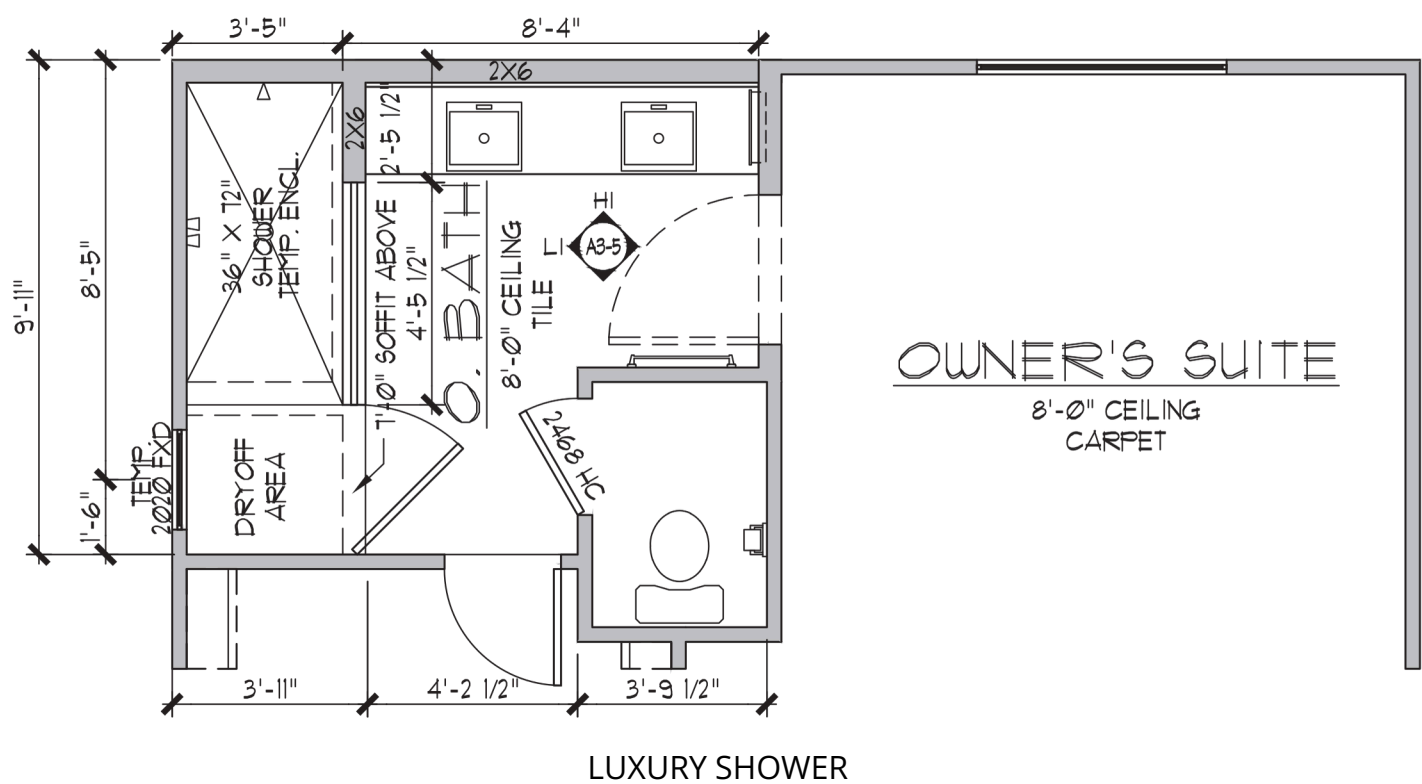

Signature

Standard Features

- Solar
- Electric Vehicle Outlet
- Our Signature Smart Home Technology Package
 - Ring Doorbell
 - MyQ Garage Opener
 - Honeywell Smart Thermostat
- Tankless Water Heater
- Paver Driveway
- Flush-Mount LED Lighting
- 8' Garage Doors

Options

- Half Length Alumawood Patio Cover with Pavers
- Full Length Alumawood Patio Cover with Pavers
- Luxury Shower
- Open Stair Railing at 2nd Floor
- Soft-Close Cabinets Throughout
- Extended Lower Cabinets from Kitchen to Dining Room
- Laundry Sink with Faucet
- 2" Faux Wood Blinds Window Covering
- Appliance Package
 - Fridge
 - Washer
 - Dryer
- Matte Black Fixture Package
- Backlit Mirrors
- Single Bowl Kitchen Sink
- Upgraded Countertops
- Upgraded Cabinets
- Upgraded Flooring
- BBQ Stub



Signature

Signature

Browse our collections at signaturehomes.com

Building
Locally
since
1978

Contact Sales

Terran Phyfer
Sales Advisor

BS.0145513

702.919.4256

terranphyfer@signaturehomes.com

